



RESIDENTIAL BATHROOM REMODEL

BUILDING DIVISION

Electrical

- A minimum of (1) 20-amp circuit is required for bathrooms. This circuit shall not contain other outlets, except, where the single 20-amp circuit supplies a single bathroom, outlets for other equipment within the same bathroom shall be permitted to be supplied in accordance with CEC 210.23 (A)(1) & (A)(2).
- At least one electrical outlet shall be installed within 36-inches of each outside edge of the sink basin and be located on the wall or partition adjacent to the sink or installed on the face or side of the basin cabinet not more than 12-inches below the countertop.
- All bathroom outlets, including those for whirlpool tubs, must be GFCI protected. CEC 210.8 (A) (1).

Mechanical

- Each bathroom must be mechanically vented and provided with humidity control. CalGreen 4.506.1.
- Backdraft dampers are required on bathroom ventilation fans. Ventilation fans must vent through an approved duct and shall terminate at the building exterior at least 3 feet from an opening or property line.

Plumbing

- Maximum flow rates: Water closets (toilets) 1.28 gals per flush; Showerheads 1.8 GPM; Sink faucets 1.2 GPM; CalGreen 4.303.
- Shower stalls shall maintain minimum dimensions of 1024 sq. inches, encompass a minimum 30-inch circle, and shall provide a non-absorbent surface to a height of 72-inches.
- Shower stall doors must open outward and provide a net clear opening of 22-inches.
- Water closets must be at least 15-inches from its center to a wall or obstruction and maintain at least 24-inches clear space in front of the bowl edge.
- For whirlpool tubs, provide a minimum 12 x 12-inch access to the slip joint tub trap and to the motor and GFCI outlet.

Lighting

- No electrical fixtures are allowed within a zone that is 3-feet horizontally and 8-feet vertically from the top of the bathtub rim.
- Recessed lighting above the shower or tub, shall be suitable for damp locations and fitted with a solid lens cover.
- Bathroom lighting shall be high efficacy type with at least one light fixture controlled by a vacancy sensor switch.



RESIDENTIAL BATHROOM REMODEL

BUILDING DIVISION

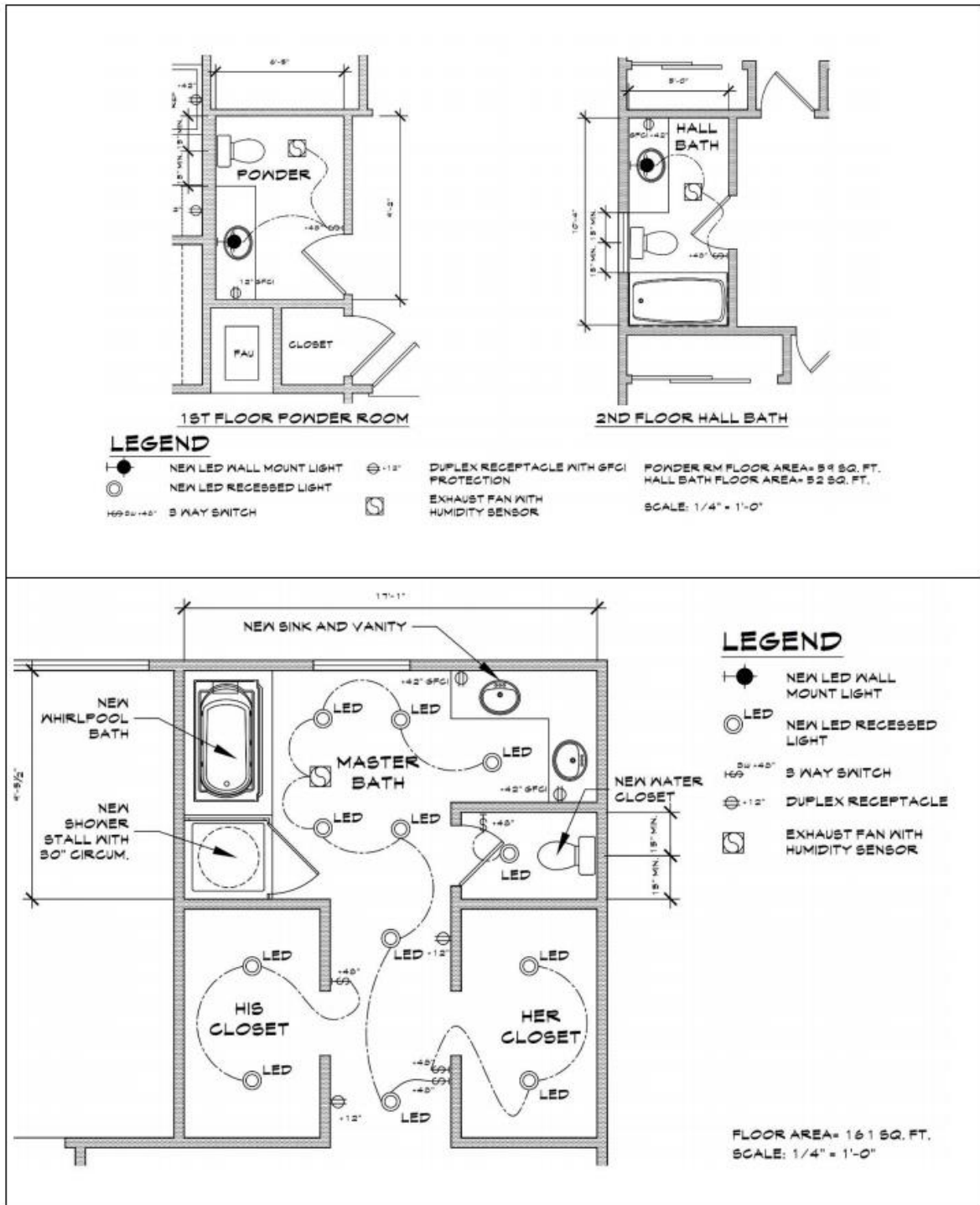

Note: For illustration purpose only